

# GEMINI *for* GEALAN S 9000

PVC-aluminium system

Aluminium cladding system for GEALAN S 9000 system windows

## PVC-ALU INSTALLATION

Aluminium frames constitute a separate structure in relation to PVC windows. They are mounted by means of system clips in the final stage of assembly after the glazing is set. This ensures separation between the two different materials and, as a result, the proper and safe operation of windows in changeable temperature conditions.

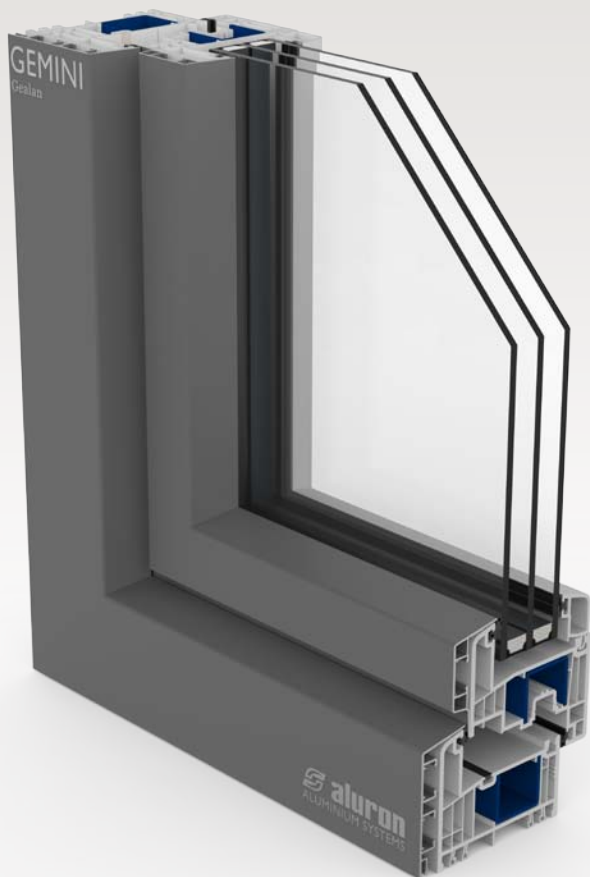

## SYSTEM FEATURES

Welded corner connections



Crimped corner connections



Assembly with system clips

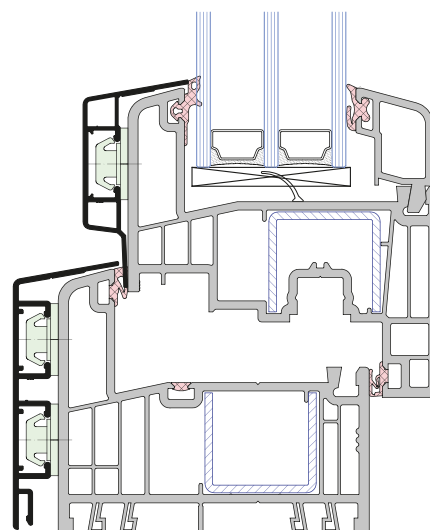

## PVC - ALU - COLOUR SCHEME

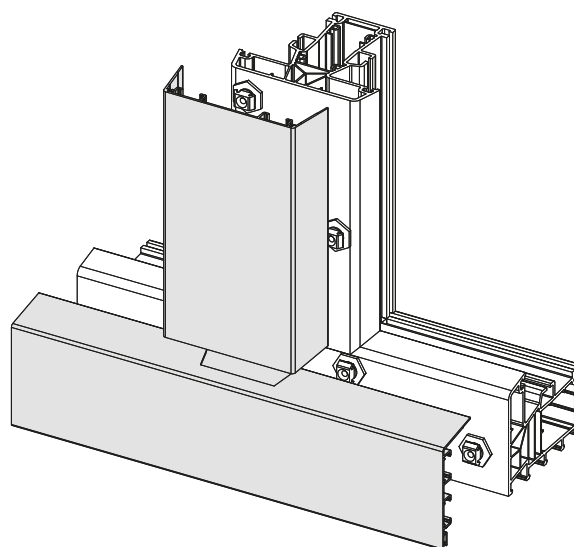

Independent  
aluminium frame  
construction